

### 4264 Series-High Performance, High Stability, with 5:1 factory Turndown Capability Flameproof Transmitters

- ▶ Gauge, Sealed and Absolute Models
- ▶ Flameproof Enclosure
- ▶ CE approved

The 4264 series provides precise repeatable measurements in a flameproof housing complete with turndown capabilities. Exceptional levels of stability and other performance specifications are achieved by using a sputtered sensing element, which achieves a molecular fusion of a strain gauge material, an insulating material, and the 17-4 PH ss sensing element.

#### Specifications

Input	
<b>Pressure Range</b>	4 bar to 690 bar
<b>Proof Pressure</b>	2 x Full Scale (FS) for Stainless Steel Units 1.5 x FS for Inconel Units
<b>Burst Pressure</b>	>35 x FS <= 10 bar ranges >15 x FS <= 100 bar ranges >8 FS <= 690 bar ranges
<b>Fatigue Life</b>	3 million FS cycles
Performance	
<b>Output</b>	4-20 mA (2 wire)
<b>Supply Voltage (Vs)</b>	8 to 40 Vdc
<b>Supply Voltage Sensitivity</b>	0.005% of max. span/Volt
<b>Long Term Drift</b>	0.1% of max span per year non-cumulative
<b>Accuracy</b>	0.1 % FS typical
<b>Thermal Error (typical)</b>	0.8% of max span for performance code E
<b>Compensated Temperatures</b>	-25° to 75° C (-13° to 167° F)
<b>Operating Temperatures</b>	-25° to 85° C (-13° to 185° F)
<b>Zero Tolerance</b>	0.1% FS, typical
<b>Span Tolerance</b>	0.1% FS, typical
<b>Zero Adjustment</b>	+/- 10% (100% at factory) by potentiometer
<b>Span Adjustment</b>	25% to 125 % of span by potentiometer
<b>Max. Loop Resistance</b>	(Vs-8) x 50 ohms
Mechanical Configuration	
<b>Pressure Port</b>	see ordering chart
<b>Wetted Parts</b>	17-4 PH ss (optional Inconel) [17-4 PH and 15-7 Mo Stainless Steel <= 1.6 bar (30 Psi)]
<b>Electrical Connection</b>	M20 thread giving access to terminal blocks, optional flameproof cable assembly
<b>Enclosure</b>	321 ss, 17-4 PH ss IP50 when used with approved cable assembly
<b>Vibration</b>	35g peak sinusoidal, 5 to 2000 Hz
<b>Acceleration</b>	100g steady acceleration in any direction 0.05% FS/g for 1 bar (15 psi) range decreasing logarithmically to 0.0001% FS/g for 690 bar (10000 psi) range.
<b>Shock</b>	Withstands free fall to IEC 68-2-32 procedure 1
<b>Approvals</b>	CE, Flameproof EEx d IIC T4 per CENELEC
<b>Weight</b>	approx. 1.5Kg



### How to Order

Use the **bold** characters from the chart below to construct a product code

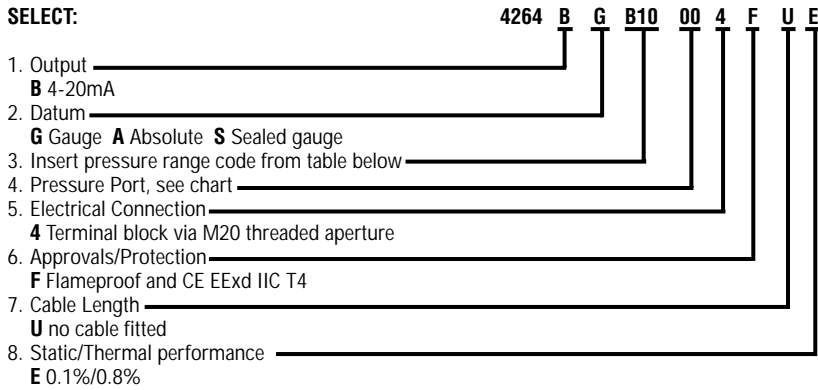

4264 Model Bar Ranges	Range Code	Gauge (G) Absolute (A) Sealed (S)
0 to 6	A60	<b>G, A</b>
0 to 10	B10	<b>G, A, S</b>
0 to 16	B16	<b>G, A, S</b>
0 to 25	B25	<b>G, A, S</b>
0 to 40	B40	<b>G, A, S</b>
0 to 60	B60	<b>G, A, S</b>
0 to 100	C10	<b>G, A, S</b>
0 to 160	C16	<b>G, A, S</b>
0 to 250	C25	<b>G, A, S</b>
0 to 400	C40	<b>G, A, S</b>
0 to 600	C60	<b>G, A, S**</b>
0 to 690	C69	<b>G, A, S**</b>

\* For compound ranges, consult sales

\*\* Internal Inconel fitting required external fitting can be SS

### Dimensions mm (in.)

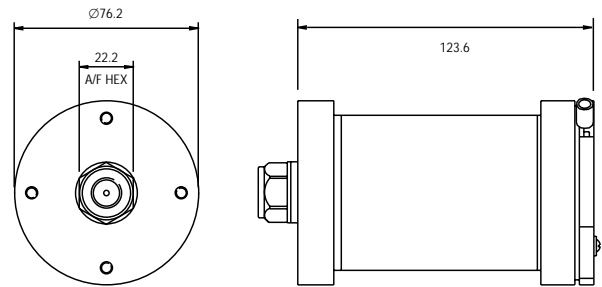

### Pressure Ports for the 4264 series

Code		
SS	Inconel	Description
OO	OK	G 1/4 internal
AO	AK	G 1/4 AT external
KO	KK	7/16-20 UNF-3A external
MO	MK	M14 x 1.5 external
PO	PK	G 1/2 AT external
BO	BK	1/4-18 npt external
GO	GK	1/2-14 npt external
SO	SK	7/16-20 UNJF-3A, MS 33656E4

Maximum diameter 76.2 mm (3")