

OVERSPEED SWITCH

AOSS90

- Heavy duty centrifugal overspeed switch
- Switching speed from 800 to 4000 rpm
- Multiple mounting possibility with Axxx90 and FAxH90 encoders
- No external power supply required
- IP 66 Protection

- Temperature range from -30 to +130 °C
- Connector and terminal box version
- Applications: steel and paper mills, crane and wood industry, etc.



AOSS9011



AOSS9012 + AINS9012
Double mounting

Specifications

| | connector/cable version | terminal box version |
|-------------------------|--|--|
| Cover | zinc alloy | treated aluminium |
| Body | aluminium | aluminium |
| Shaft | stainless steel | stainless steel |
| Speed | continuous 6000 min ⁻¹ short term 9000 min ⁻¹ maximum 1,5 · n _s | continuous 6000 min ⁻¹ short term 9000 min ⁻¹ maximum 1,5 · n _s |
| Torque | ≤ 10 · 10 ⁻³ Nm | ≤ 10 · 10 ⁻³ Nm |
| Loading | Axial 100 N, Radial 200 N | Axial 100 N, Radial 200 N |
| Protection | IP 66 | IP 66 |
| Temperature | -30 °C ... +130 °C | -30 °C ... +130 °C |
| Weight | 1.1 kg | 1.3 kg |
| Switching speed | 800 ... 4000 min ⁻¹ | 800 ... 4000 min ⁻¹ |
| Principle | centrifugal | centrifugal |
| Contact type | NO, NC | NO, NC |
| Max. current | 6 A/240 VAC | 6 A/240 VAC |
| Max. switching sequence | 4/min. | 4/min. |
| Switching accuracy | -5 ... +8 % of n _s | -5 ... +8 % of n _s |
| tolerance | appr. 3 % between cw and ccw | |
| Speed hysteresis | 40 % below n _s | 40 % below n _s |

n_s = switching speed (factory calibrated)

Terminal assignment

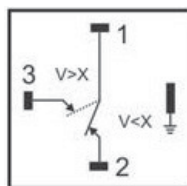

Dimensioned drawing

Overspeed switches AOSS9011

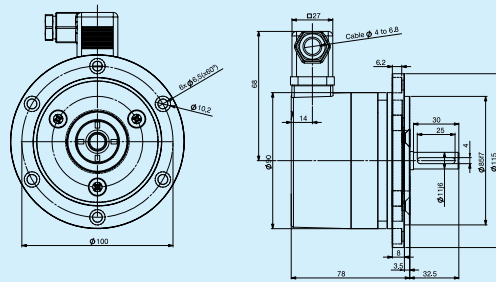

AOSS9012

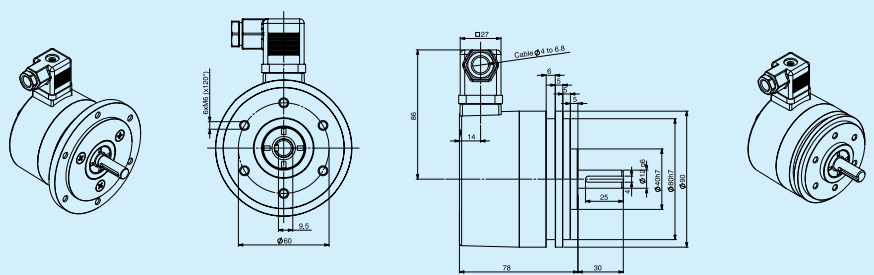

Overspeed switch - encoder combinations

AOSS90 + AINS90xx

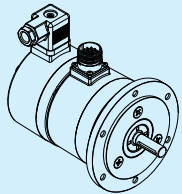

AOSS90 + AINS90xx with 2 incremental outputs

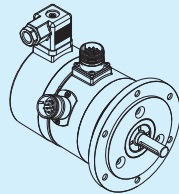

AOSS90 + AINH90xx with meflex coupling

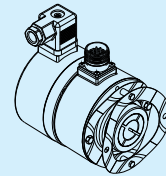

AOSS90 + AINS90xx in 1 housing

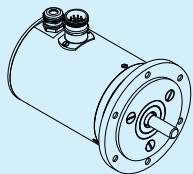

AOSS90 + AINH90xx + AINH90xx with 2 incremental outputs

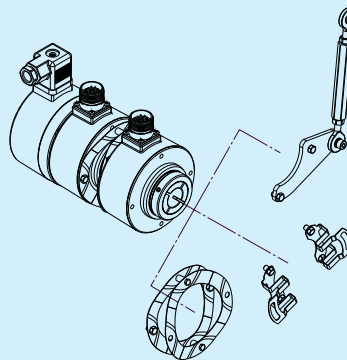

AOSS90 + AINH90xx + FAxH90 with 1 incremental + 1 absolute/ bus output

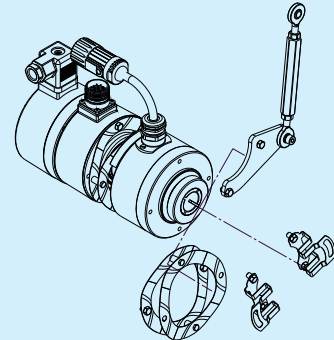

ORDERING CODE

AOSS90

Shaft-Ø
11 = 11 mm
12 = 12 mm
CE = Combination
with encoder

Connection
1R = 4pin solenoid
valve connector
BR = terminal box

Resolution
800
1000
1200
1500
1800
3000
4000
Other switching speeds
on request

Ordering code example for overspeed switch-encoder combination
AOSS90CE1R1500 + AINS9011596R1024

Technical specifications of encoders, refer to related incremental or absolute encoder data sheets



Meyer Industrie-Electronic GmbH - MEYLE
Carl-Bosch-Straße 8 Tel.: +49 54 81-93 85-0 Internet: www.meyle.de
49525 Lengerich/Germany Fax: +49 54 81-93 85-12 E-Mail: sales@meyle.de